

Kitchen Pantry Cabinet

By **Jaime Costiglio**

Difficulty

Advanced

A freestanding pantry cabinet perfect for storage and additional counterspace. Makes a great addition for small home with no pantry or apartment living and adds counterspace for serving or bar set up. Alternatively provides great storage for your office space, craft room or work room.





Tools

Kreg Tools



Other Tools

- Circular Saw (corded)
- Jigsaw
- Miter Saw
- Square
- Tape Measure
- Drill (cordless)
- Nail Gun
- Sander
- Shop Vacuum

Materials

Wood Products

- 2 Plywood , 3/4" Thick , Full Sheet
- 1 Plywood , 1/4" Thick , Full Sheet
- 1 Board , 1x4 , 96"
- 3 Board , 1x8 , 96"
- 3 Board , 1x3 , 96"

Hardware & Supplies

- 50 1 1/4" Pocket Hole Screws
- 20 1 1/4" Wood Screws
- 20 3/4" Wood Screws
- 30 1" Finish Nails
- 6 Cabinet Hinges Full Wrap
- 2 Hardware Pulls
- 2 Magnetic Latches
- 4 Shelf Pins
- 1 Wood Glue

Cut List & Parts

- 1** Top , 3/4" X 36" X 24"
- 1** Bottom , 3/4" X 34 1/2" X 23"
- 2** Sides , 3/4" X 35 1/4" X 14 7/8"
- 3** Undertop & Shelves , 3/4" X 33" X 14 7/8"
- 2** Base Trim Sides , 1x4 @ 36"
- 1** Base Trim Front , 1x4 @ 36"
- 1** Backing , 1/4" X 35 1/4" X 34 1/2"
- 4** Sides , 1x8 @ 31 1/2"
- 8** Top, Bottom & Shelves , 1x8 @ 15 5/8"
- 6** Shelf Trim , 1x3 @ 15 5/8"
- 2** Backing , 1/4" X 31 1/2" X 17 1/8"
- 4** Trim Sides , 1x3 @ 31 1/2"
- 4** Trim Top & Bottom , 1x3 @ 12 1/8"

Directions

1

Dimensions

Overall dimensions: 36"w x 24"d x 36"h

PANTRY
SIDEBOARD
CABINET

thatsmyletter.blogspot.com

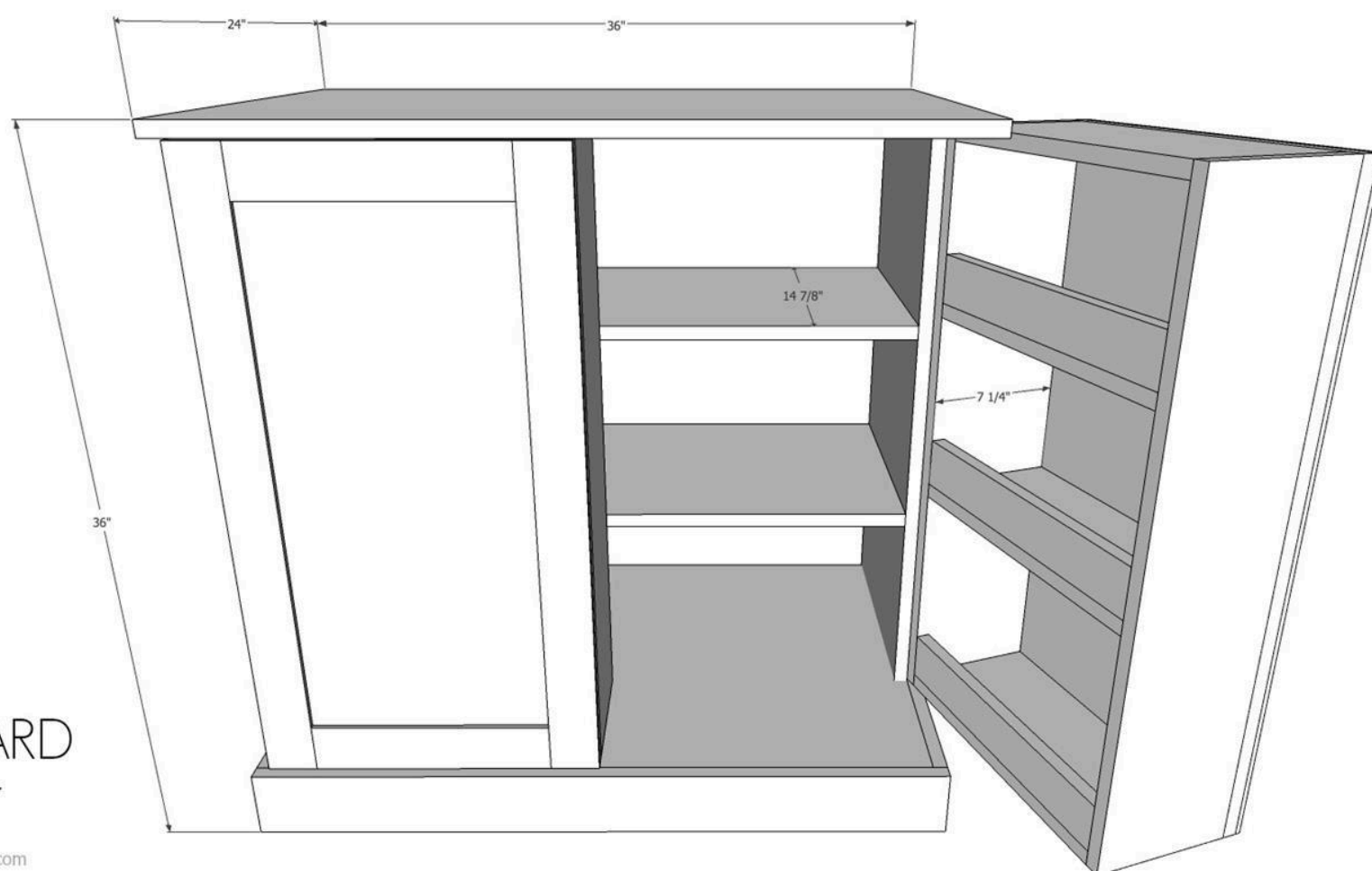

2**Step 1**

Attach sides to undertop using wood glue and 1 1/4" pocket hole screws.

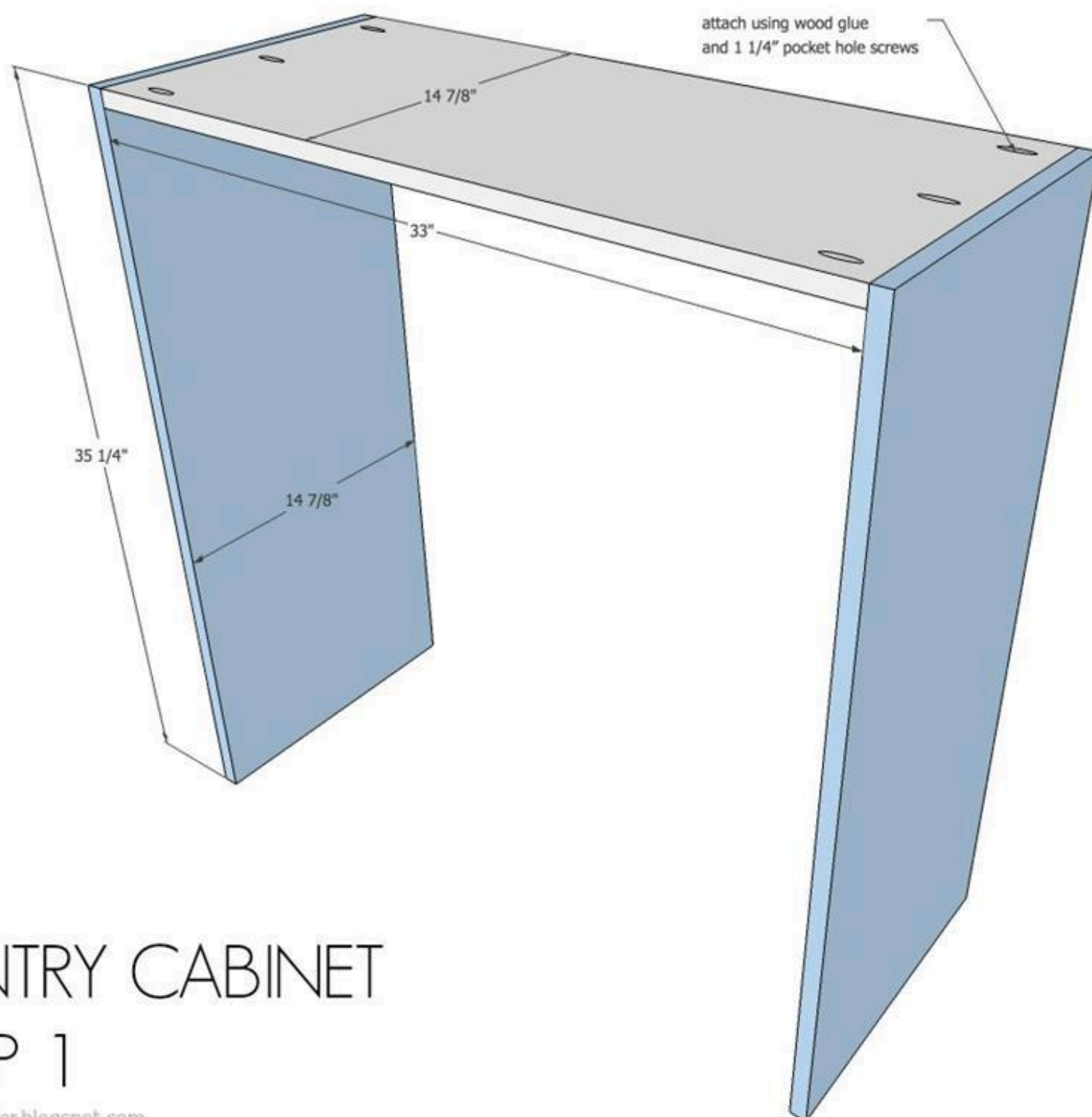

PANTRY CABINET STEP 1

thatsmyletter.blogspot.com

3

Prep for Step 2

Using a jig saw notch out bottom piece at sides as per sketch above.

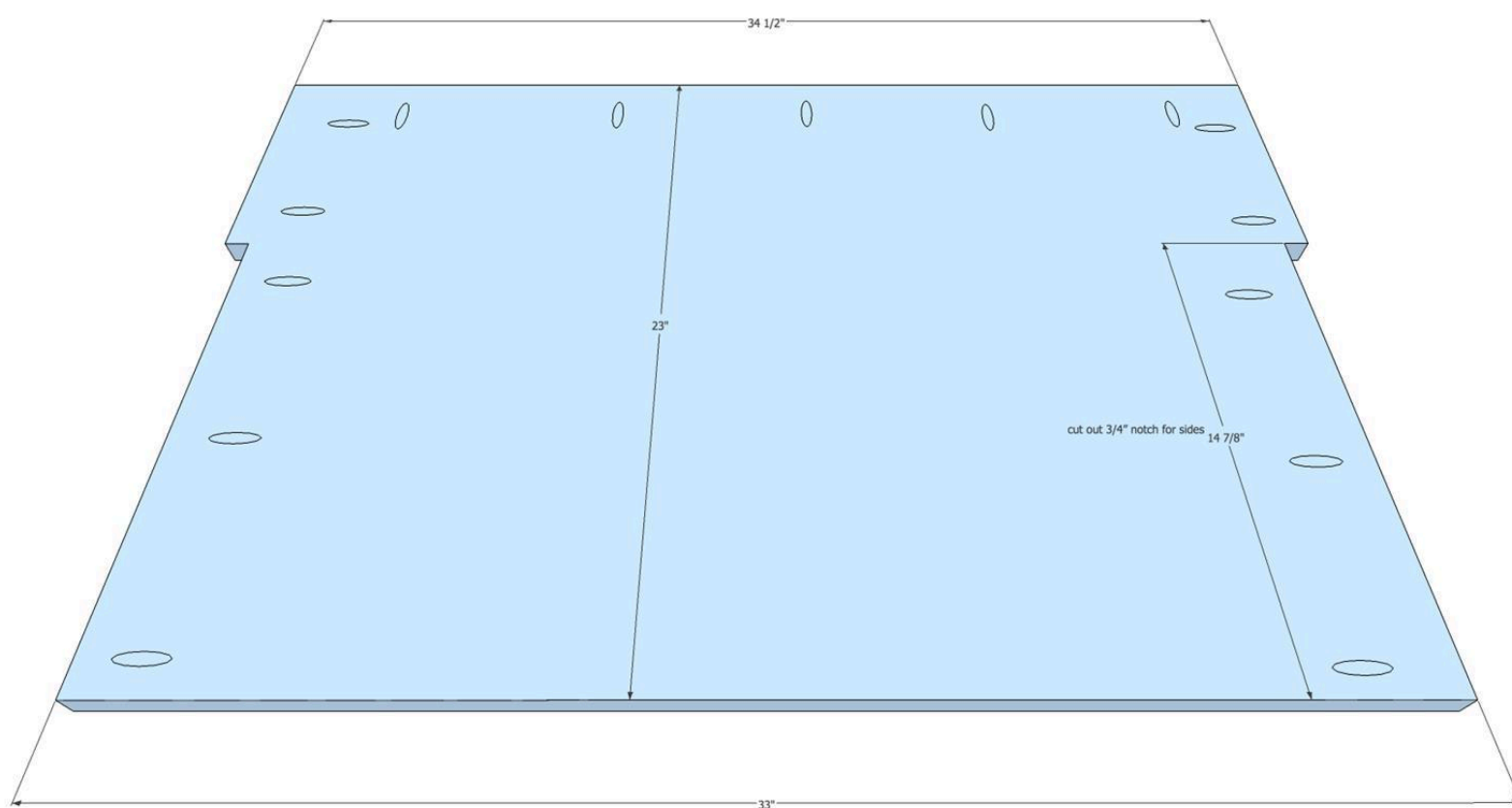

4

Step 2

Attach bottom to sides using wood glue and 1 1/4" pocket hole screws.

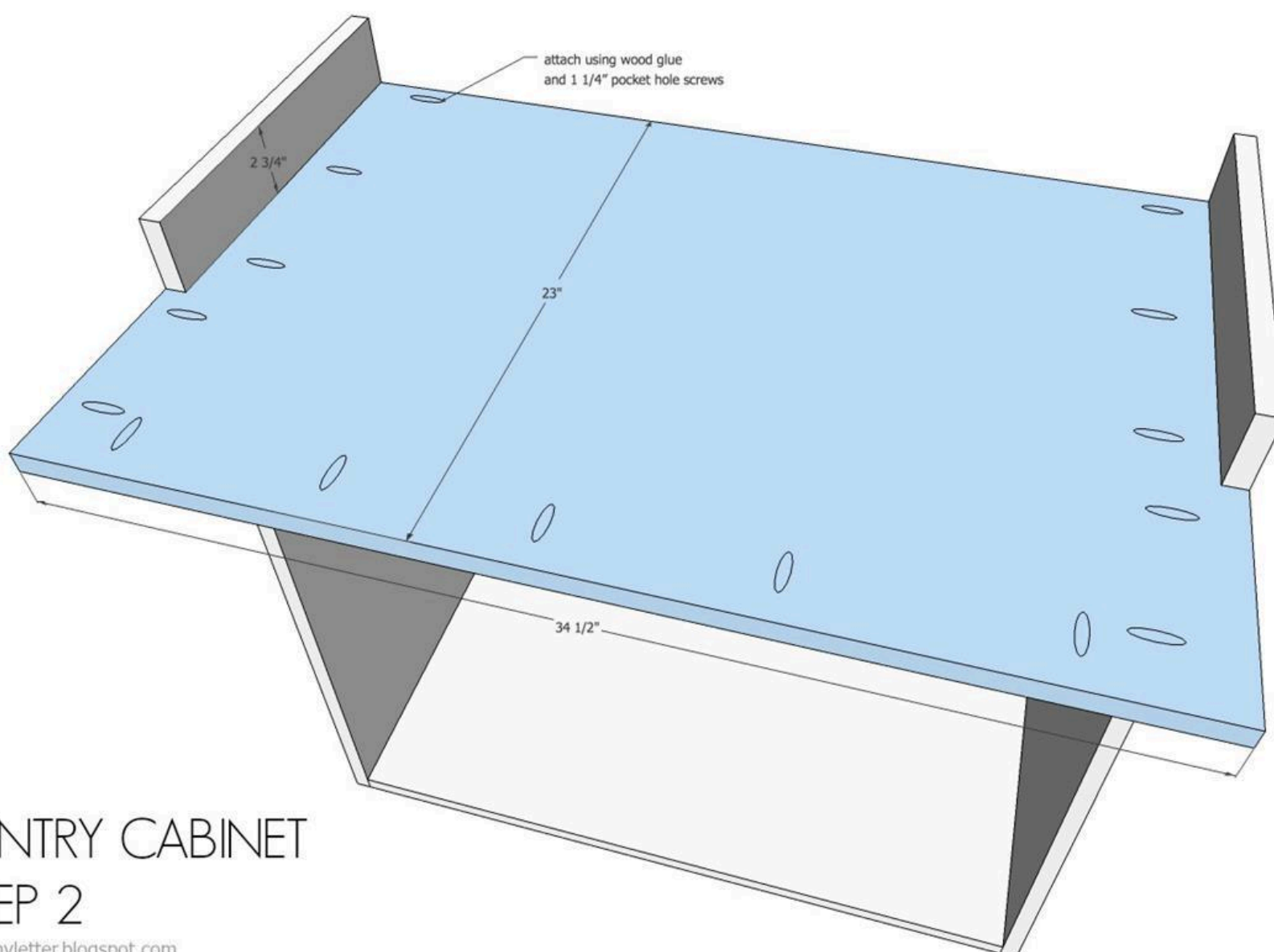

PANTRY CABINET
STEP 2

thatsmyletter.blogspot.com

5**Step 3**

Attach shelves as desired. I suggest making one fixed shelf and one movable shelf. For the fixed shelf attach using wood glue and 1 1/4" pocket hole screws.

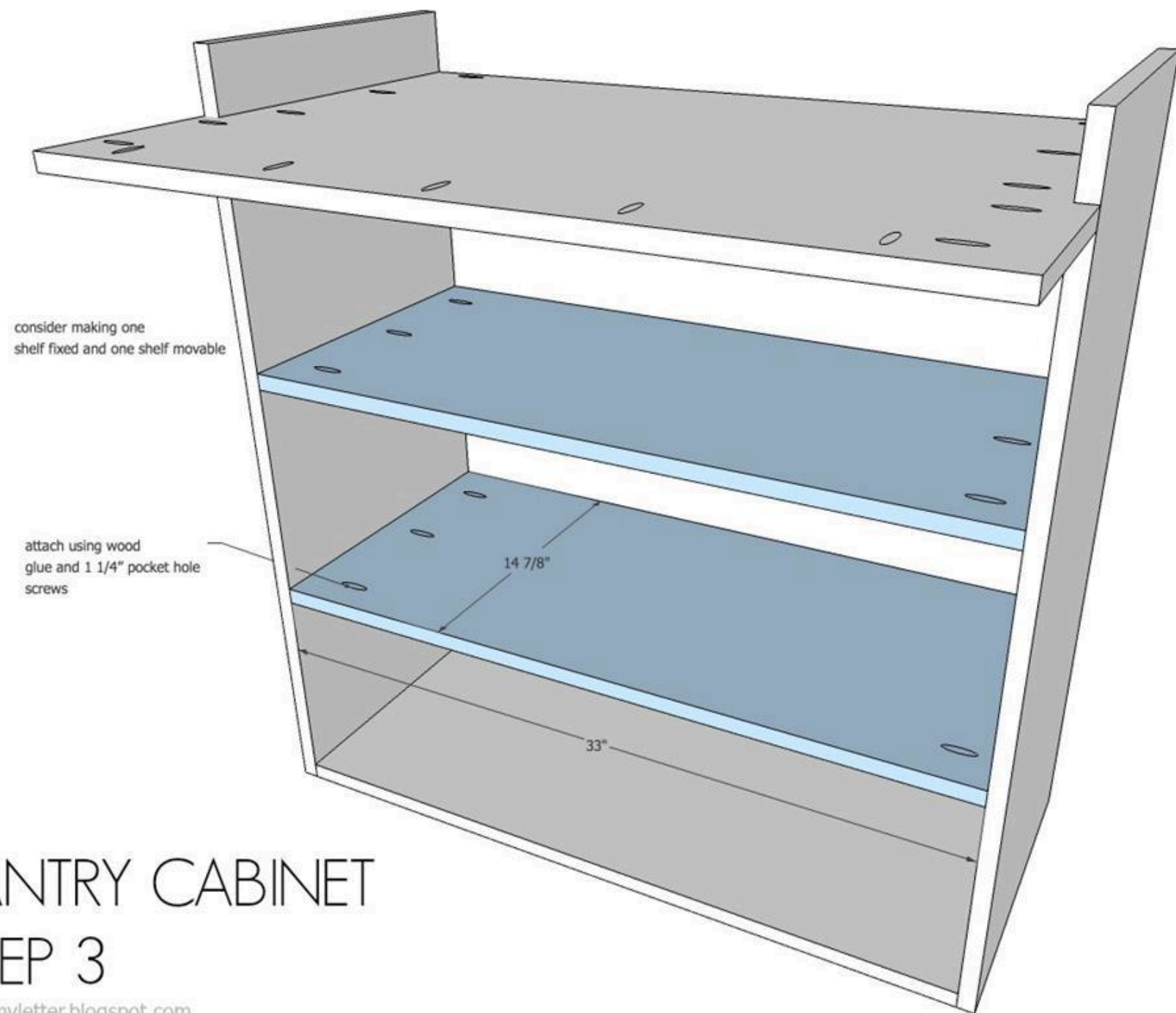

PANTRY CABINET STEP 3

thatsmyletter.blogspot.com

6

Step 4

Attach top to undertop using wood glue and countersunk 1 1/4" wood screws. Leave 1/4" overhang at back and 3/4" overhang on both sides.

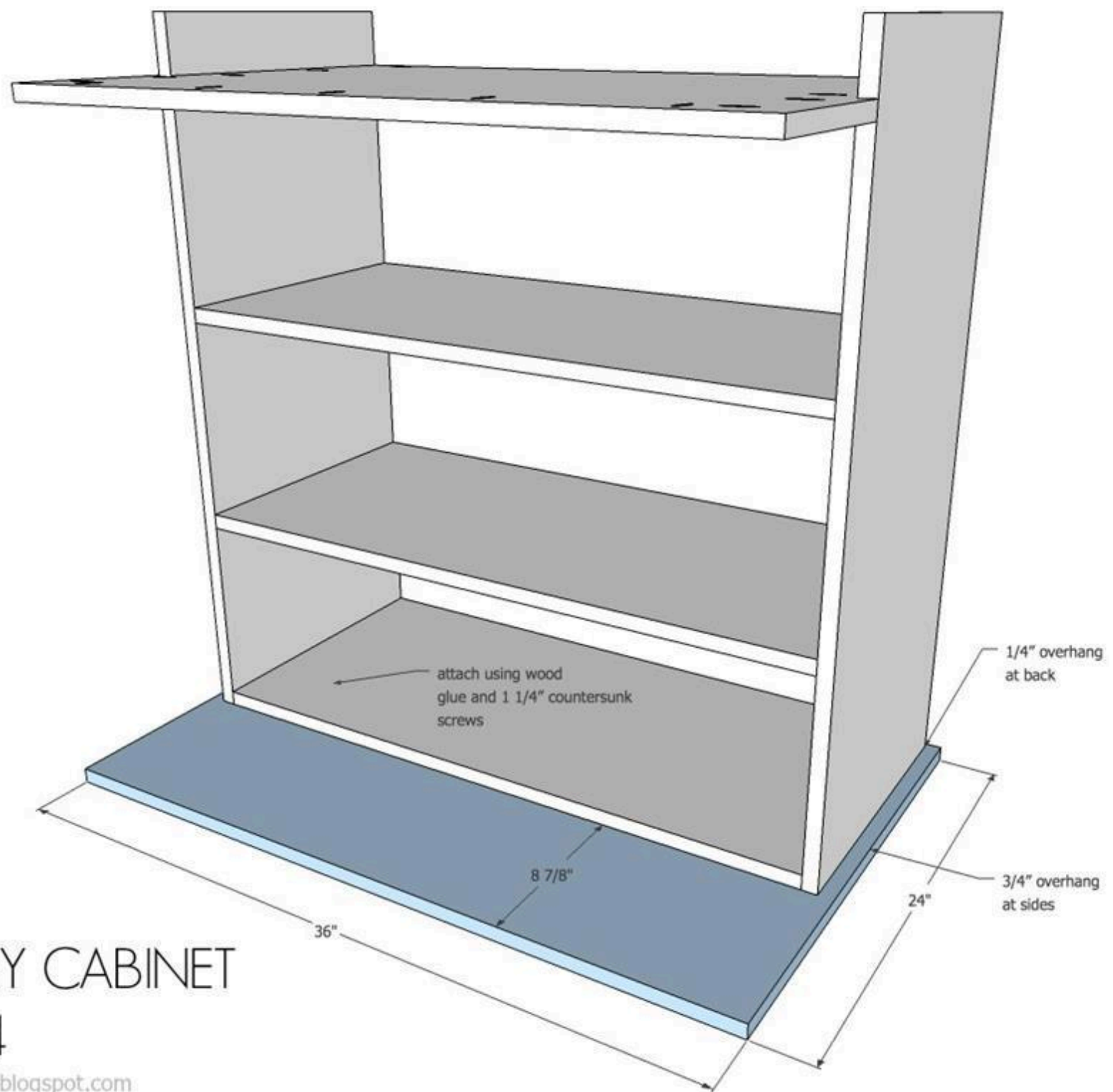

PANTRY CABINET STEP 4

thatsmyletter.blogspot.com

7

Step 5

Attach base trim sides to carcass sides using wood glue and countersunk 1 1/4" wood screws. Attach front portion to bottom piece using 1 1/4" pocket hole screws.

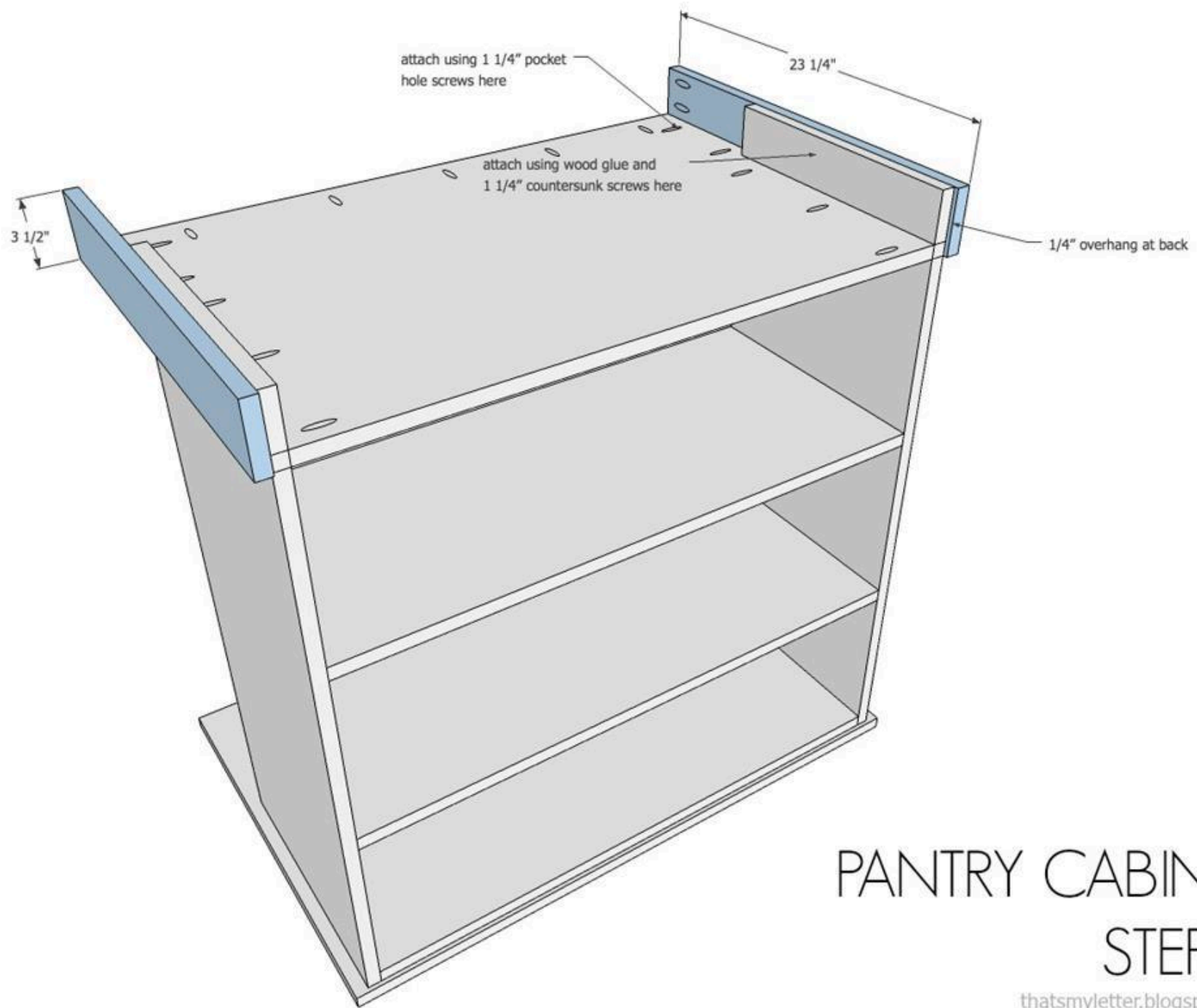

PANTRY CABINET STEP 5

thatsmyletter.blogspot.com

8**Step 6**

Attach front base trim to bottom piece using wood glue 1 1/4" pocket hole screws. Also attach to base trim side pieces using 1 1/4" pocket hole screws.

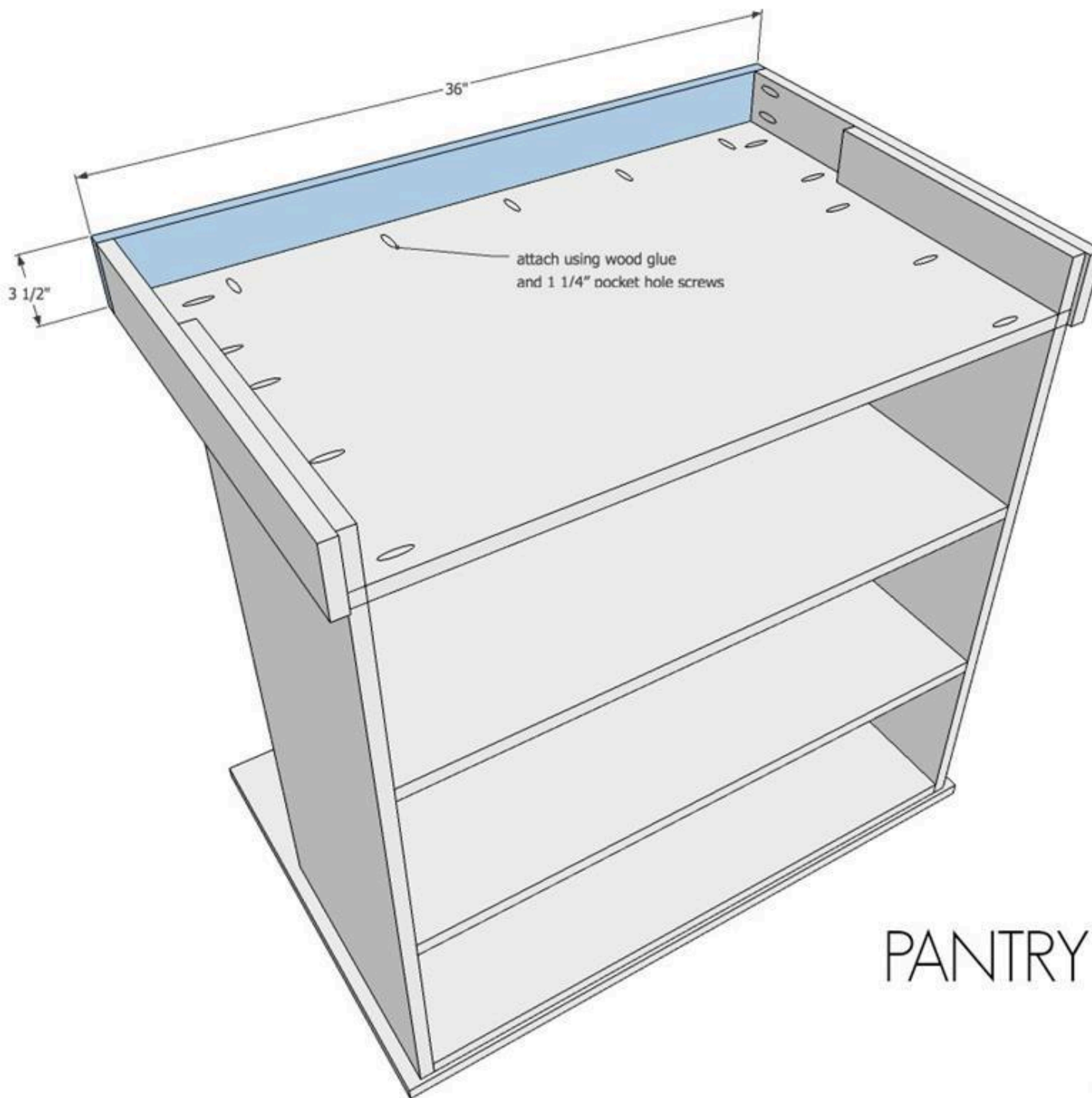

PANTRY CABINET
STEP 6

thatsmyletter.blogspot.com

9**Step 7**

Attach backing to carcass using wood glue and $\frac{3}{4}$ " countersunk wood screws.

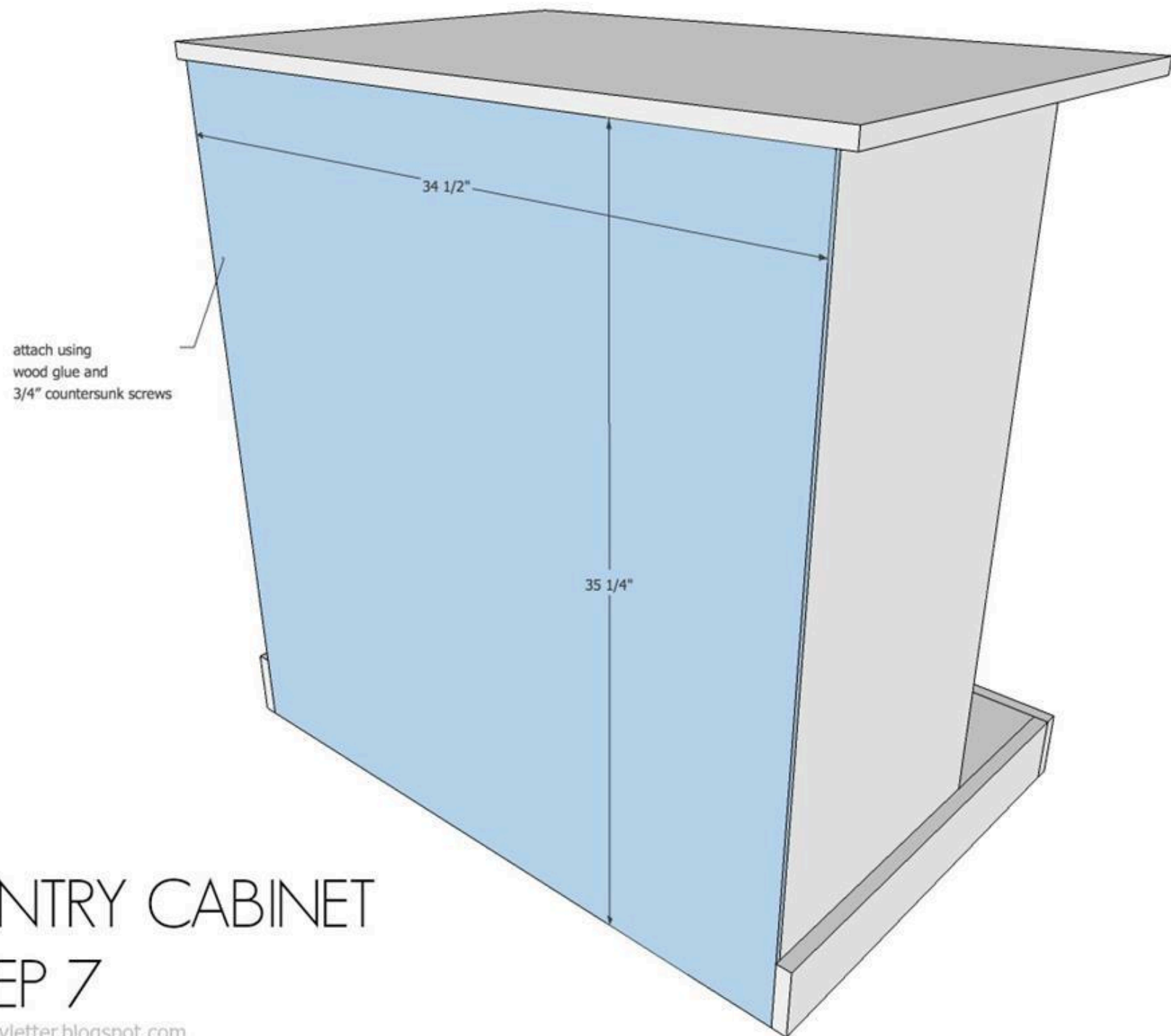

PANTRY CABINET STEP 7

thatsmyletter.blogspot.com

10

Door Dimensions

Overall door dimensions: 17 1/8" w x 31 1/2" h x 8 1/4" d

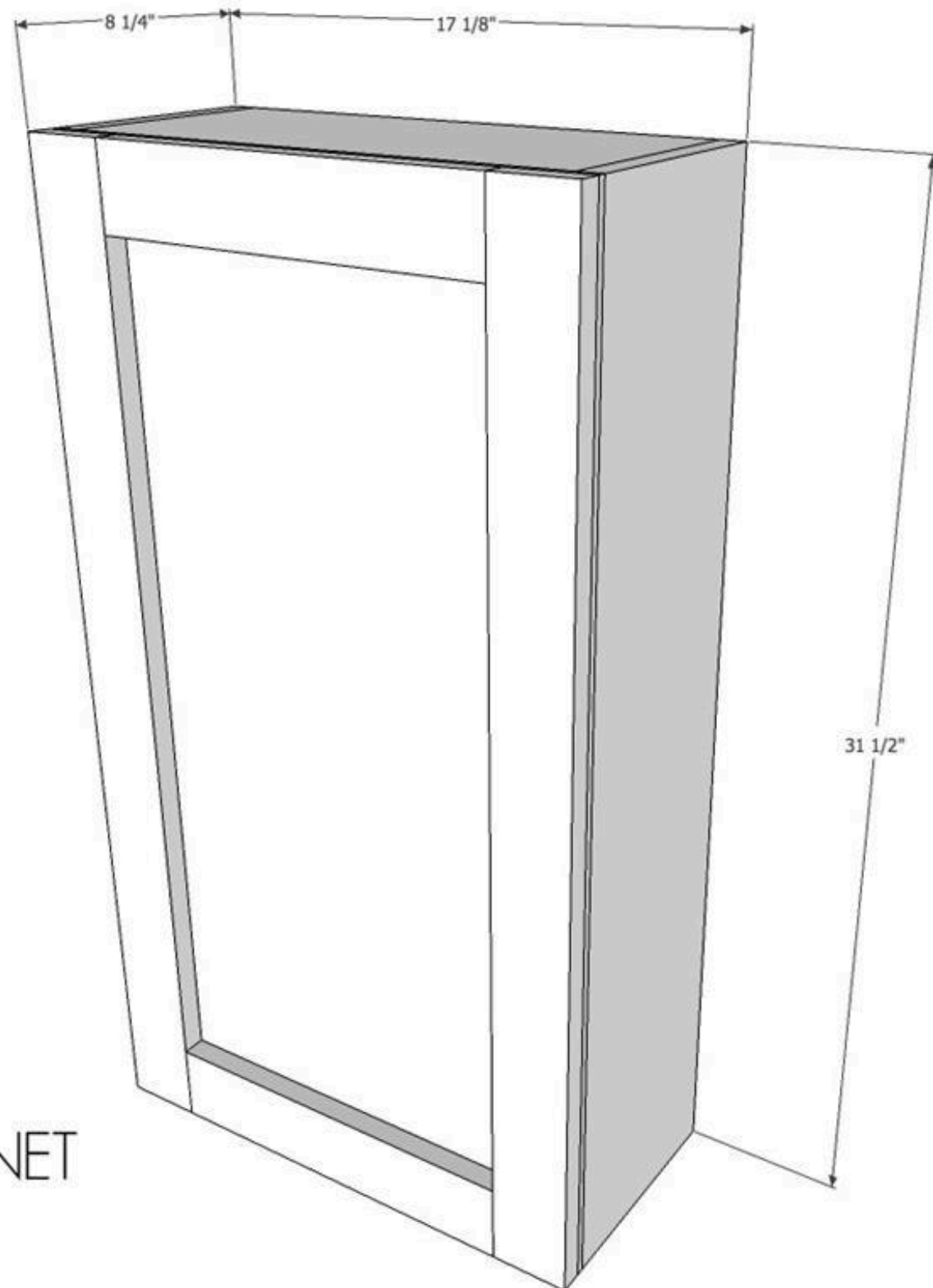

PANTRY CABINET
DOOR

thatsmyletter.blogspot.com

11

Door Step 1

Make door frame by attaching top and bottom to sides using wood glue and 1 1/4" pocket hole screws.

thatsmyletter.blogspot.com

PANTRY CABINET DOOR STEP 1

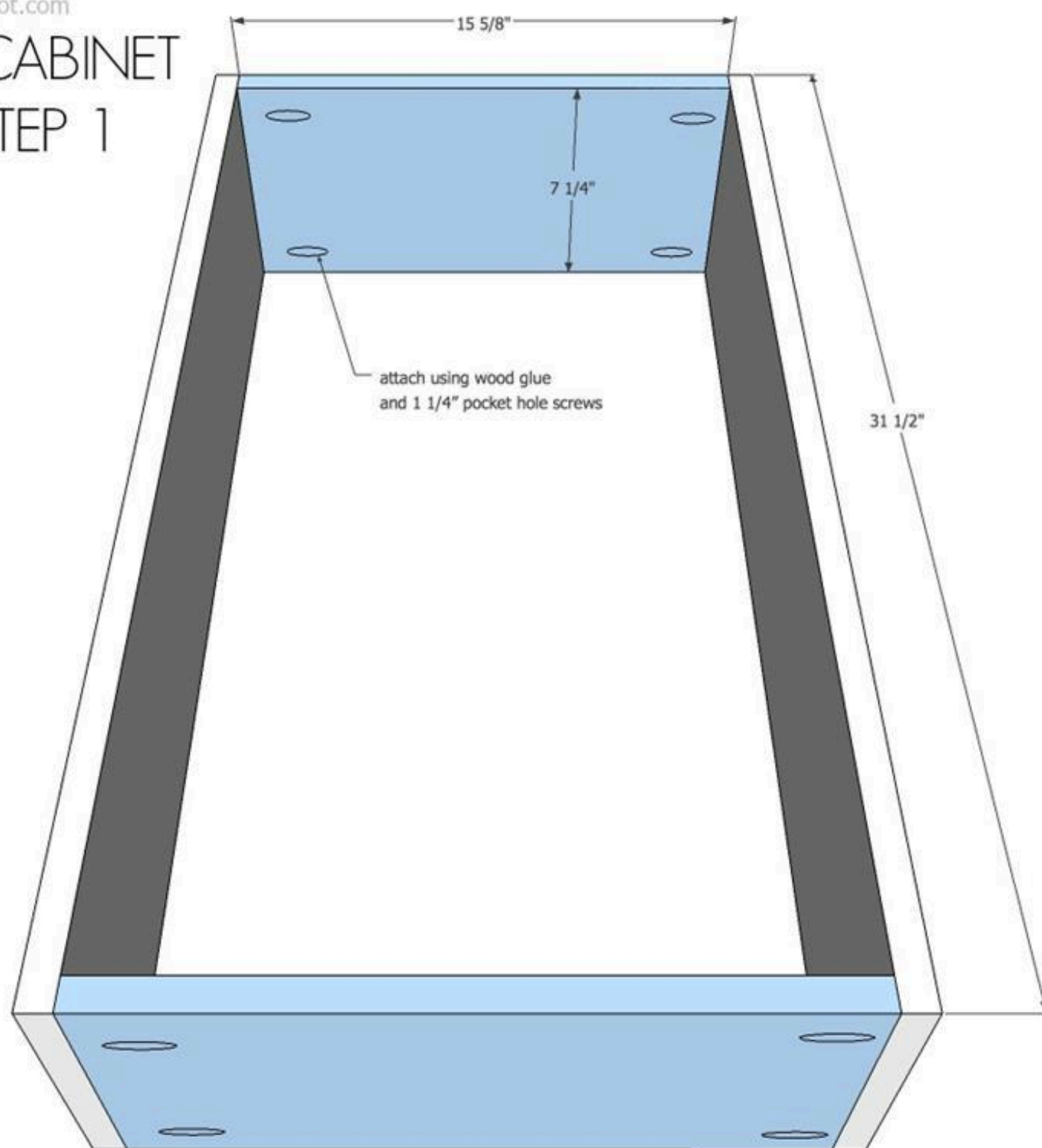

12**Door Step 2**

Insert shelves using wood glue and 1 1/4" pocket hole screws.

thatsmyletter.blogspot.com

PANTRY CABINET DOOR STEP 2

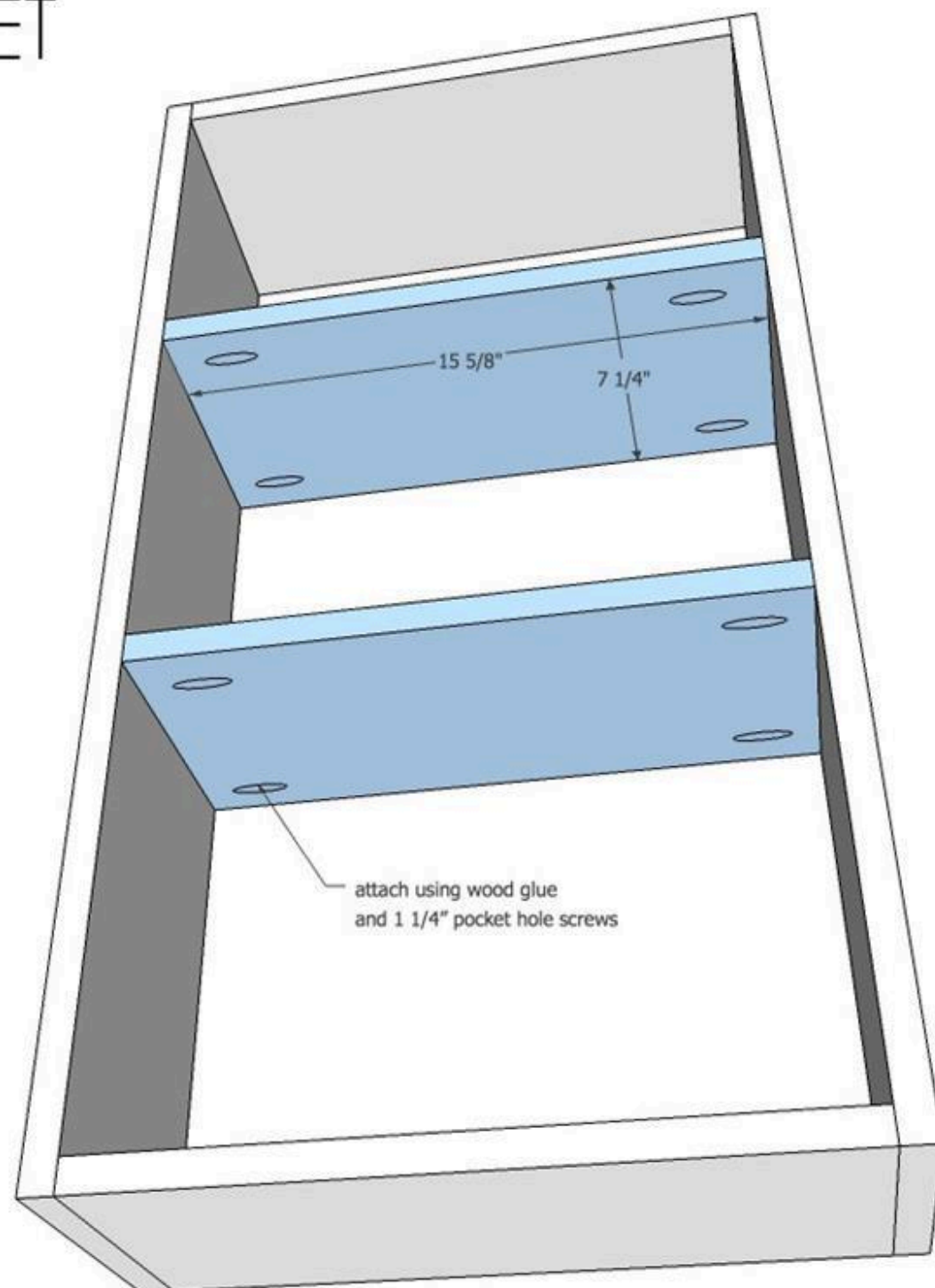

13

Door Step 3

Attach shelf trim flush to front using wood glue and 1 1/4" pocket hole screws at sides and secure to shelf at underside using 1 1/4" finish nails.

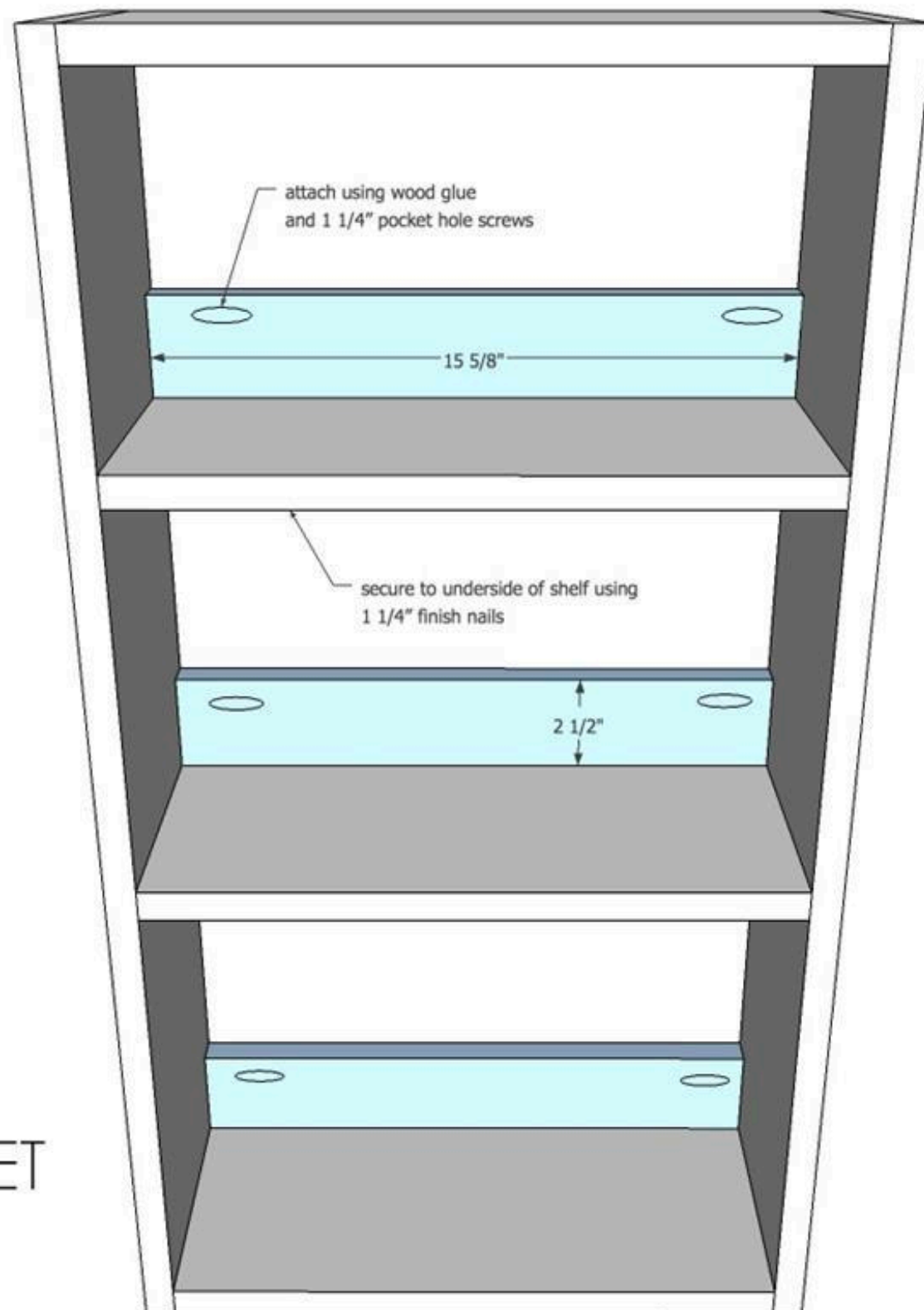

PANTRY CABINET
DOOR STEP 3

thatsmyletter.blogspot.com

14

Door Step 4

Attach backing to door frame using wood glue and countersunk 3/4" wood screws.

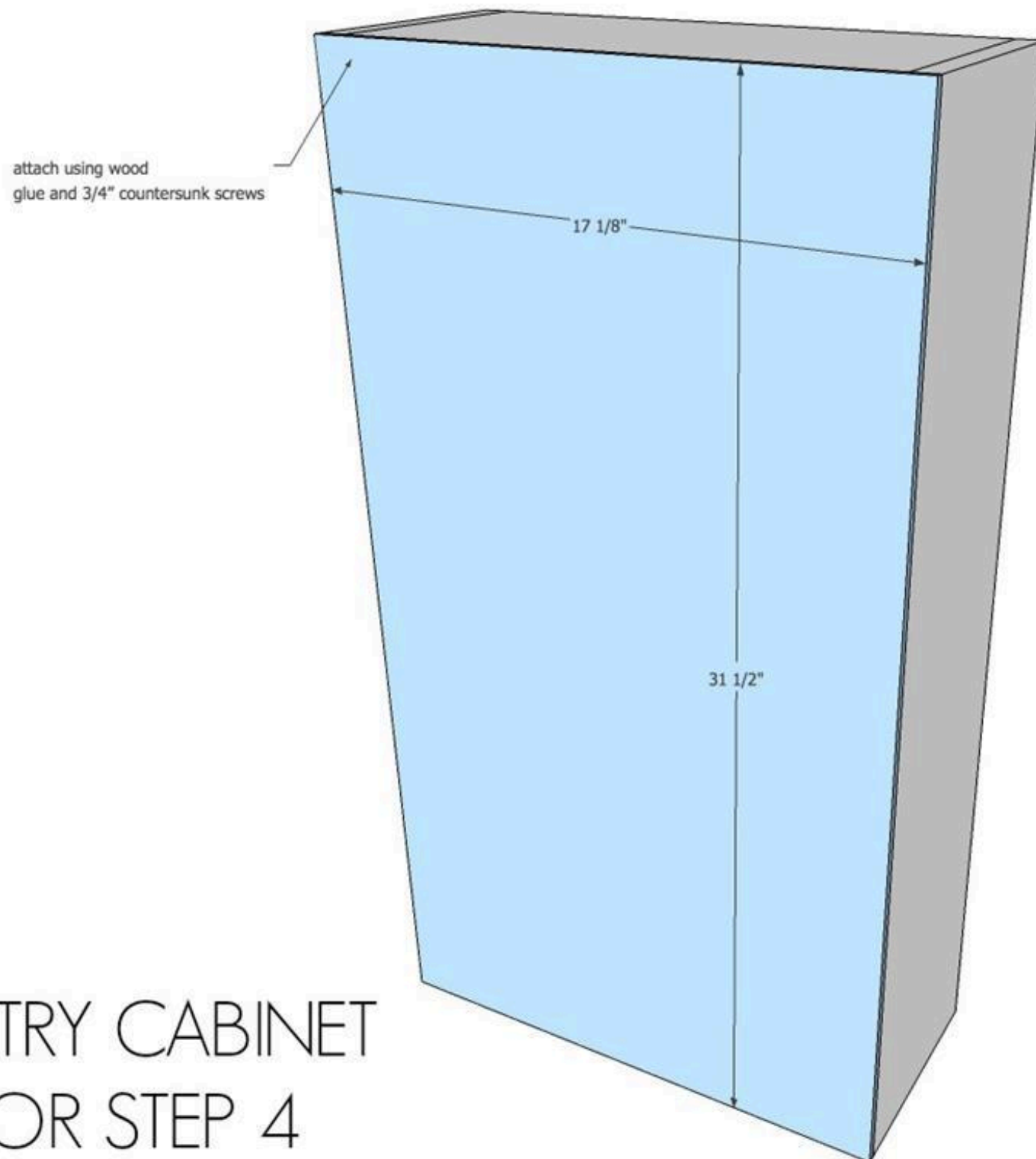

PANTRY CABINET
DOOR STEP 4

thatsmyletter.blogspot.com

15

Door Step 5

Attach trim pieces using wood glue and 1" finish nails.

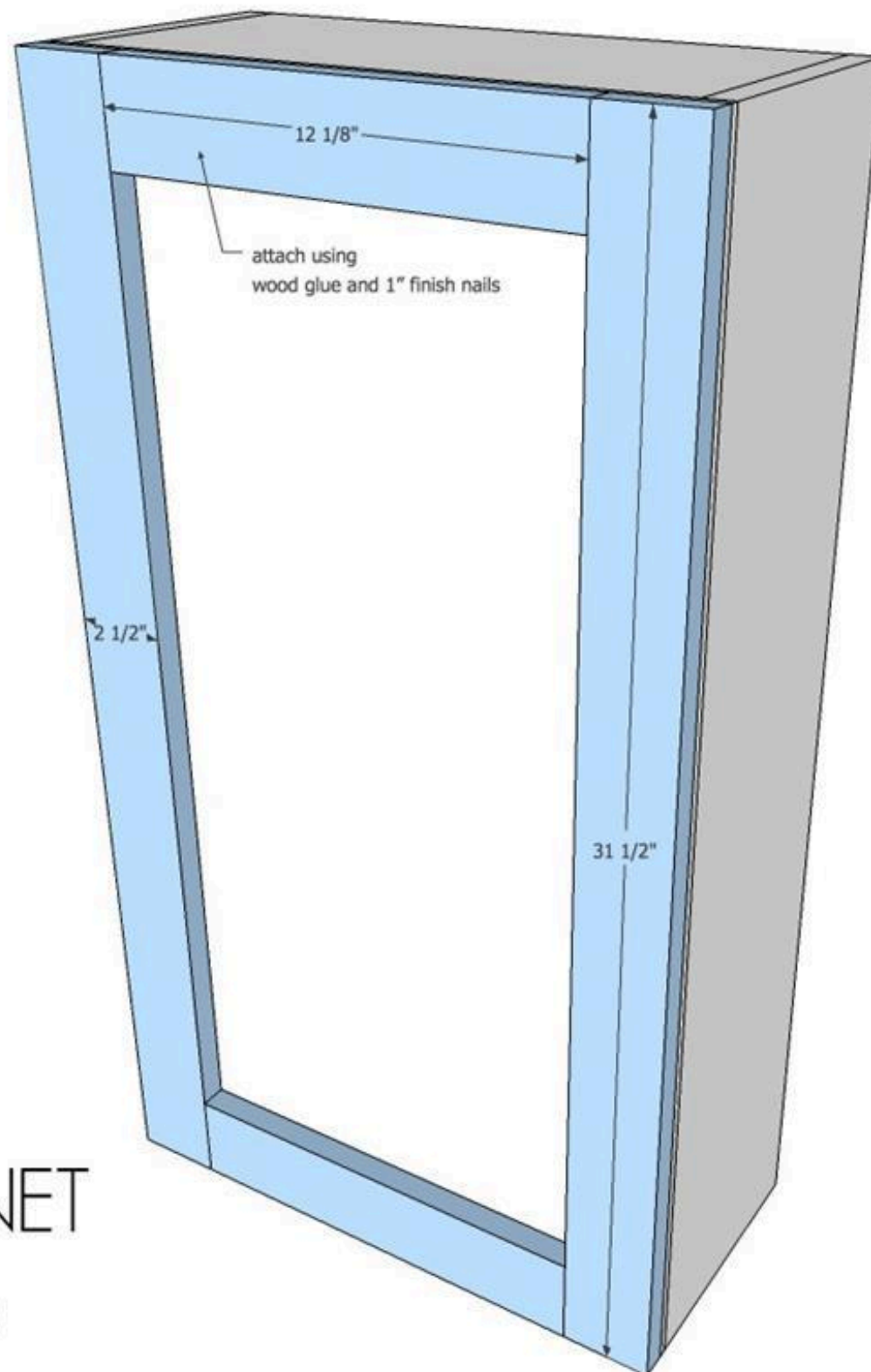

PANTRY CABINET DOOR STEP 5

thatsmyletter.blogspot.com